

**1 A FIBERGLASS CANOPY**

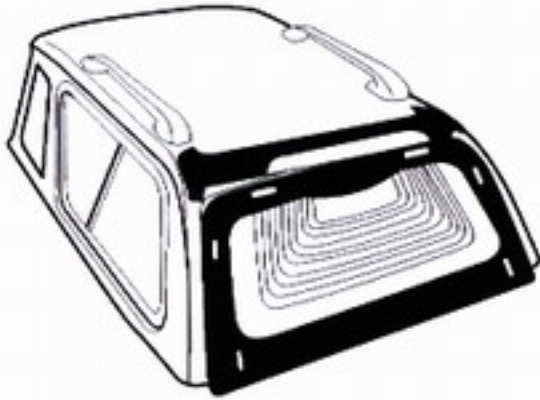

**2 6 SETS OF KWICK KLAMP S5**

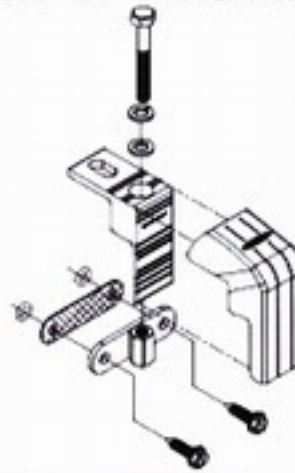

**3 1 ROLL OF RUBBER TRUCK BED EDGE**



**INSTALLATION STEPS**

**1** Clean the pick up especially the truck bed edge and the rear glass. (refers to figure A)

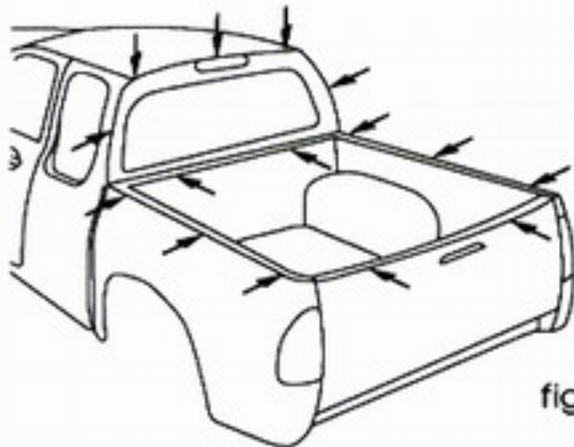

figure A.

**2** Attach the rubber stripe support on the sides and the front of the pick up bed. (refers to figure B)

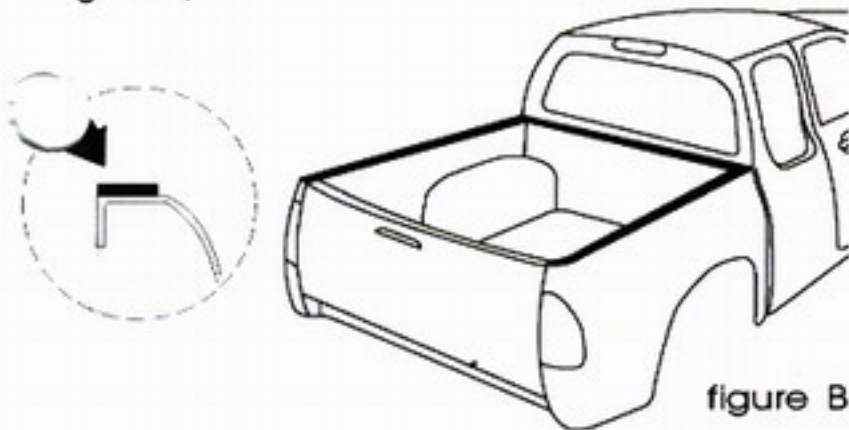

figure B.

**3** Put the Fiberglass canopy on the top of the bed edge as per figure C and adjust it properly to be well-fitted to the body. (refers to figure D and E)

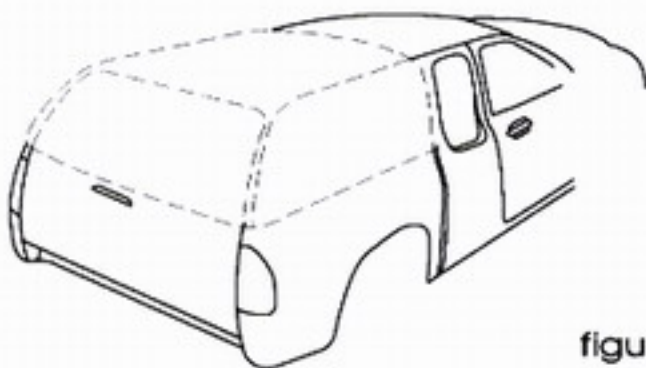

figure C.

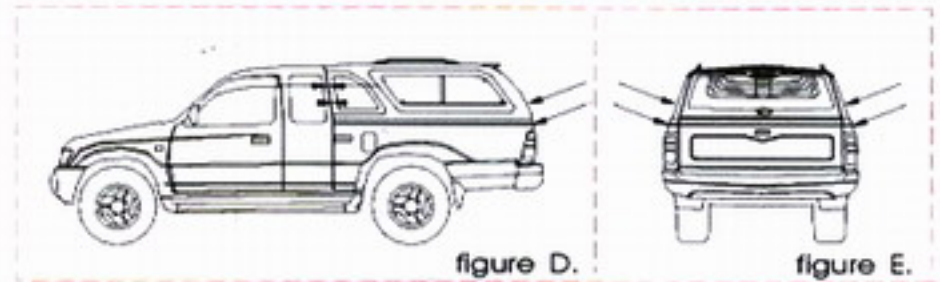
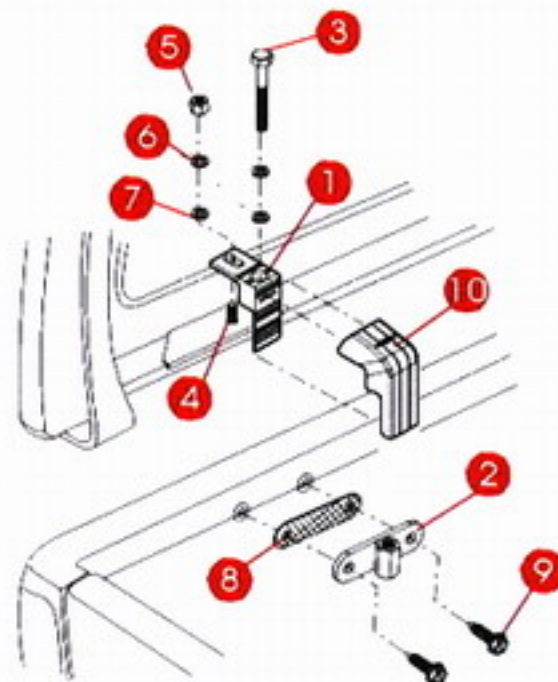

figure D.

figure E.

**4** Placing the fiberglass to the truck bed with the set of KWICK KLAMP S5 as in the picture by using M8 x 70mm. **3** to the upper KWICK KLAMP **1**. After that, bring this Upper KWICK KLAMP **1** to insert into M8 bolt **4** and hold it with M8 Nut **5**, Spring Washer M8 **6**, and plain washer M8 **7** tightly. Adjusting the position of lower KWICK KLAMP S5 **2** to fit properly with the body.



Then placing the shim **8** under KWICK KLAMP S5 **2**. Screwing the nut 1/4 x 1" **9**, then fixing the bolt M8 x 70mm. **3** tightly. Finally, placing the plastic cover on the installed KWICK KLAMP S5 **10** at 6 positions. (refers to figure F)

Position of assemble KWICK KLAMP

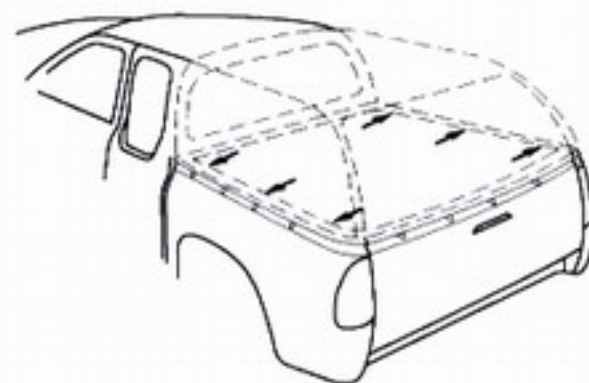
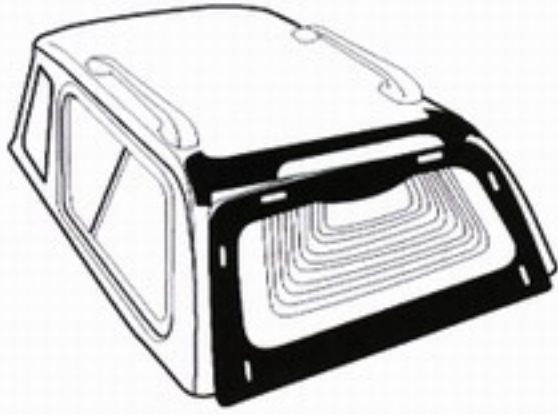
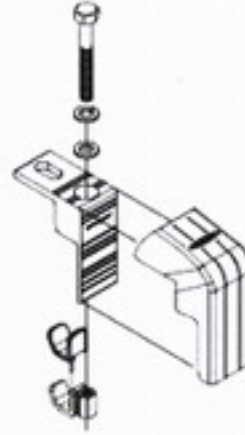

figure F.

**1 A FIBERGLASS CANOPY**



**2 6 SETS OF KWICK KLAMP S5**



**3 1 ROLL OF RUBBER TRUCK BED EDGE**



### INSTALLATION STEP

**1** Clean the pick up especially the truck bed edge and the rear glass. (refers to figure A)

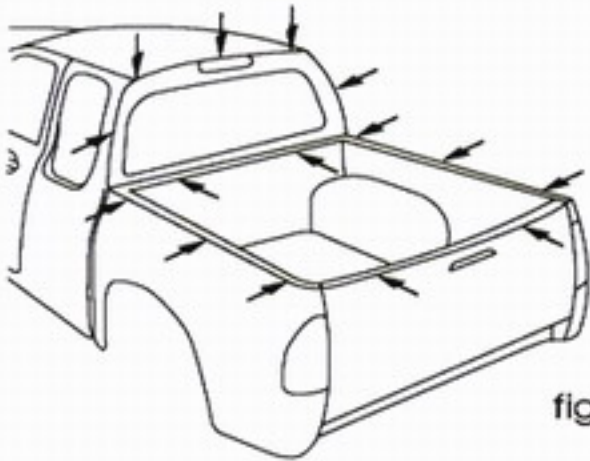

figure A.

**2** Attach the rubber stripe support on the sides and the front of the pick up bed. (refers to figure B)

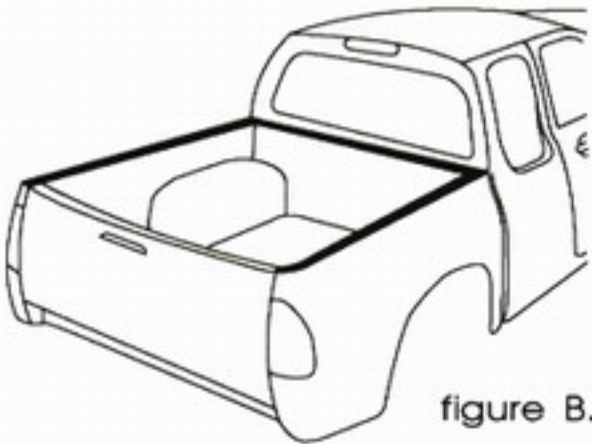

figure B.

**3** Put the Fiberglass canopy on the top of the bed edge as per figure C and adjust it properly to be well-fitted to the body. (refers to figure D and E)

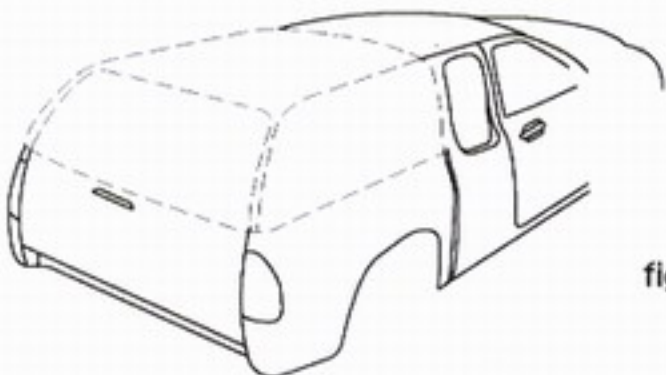

figure C.

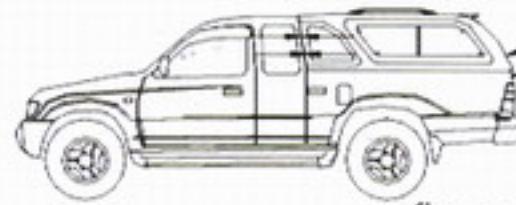
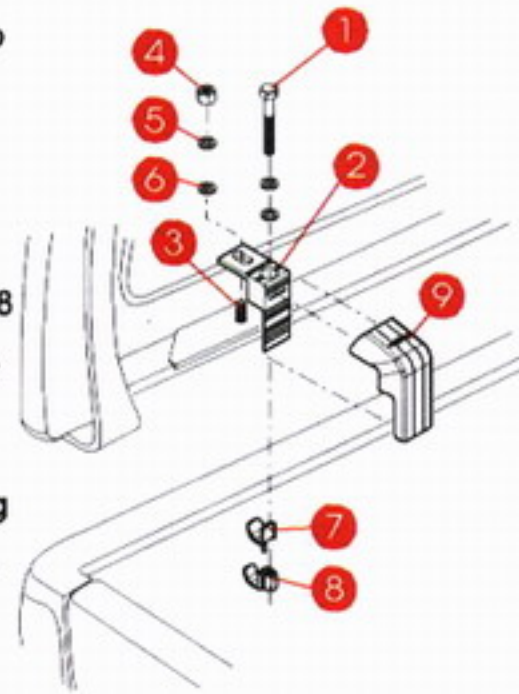

figure D.



figure E.

**4** Attach the fiberglass canopy to the truck bed with KWICK KLAMP S4 set by using bolt M8 x 70 **1** on the upper KWICK KLAMP **2**. Insert to the bolt M8 **3**. Tighten up with Nut M8 set **4**, spring washer M8 **5** and plain washer M8 **6**. Then bring the lower KWICK KLAMP rubber support **7** to combine with the lower KWICK KLAMP **8**.



**Position of assemble KWICK KLAMP**

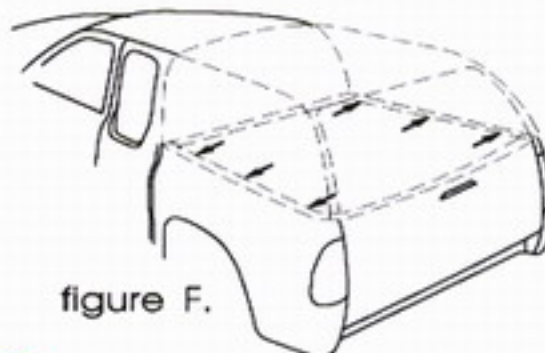
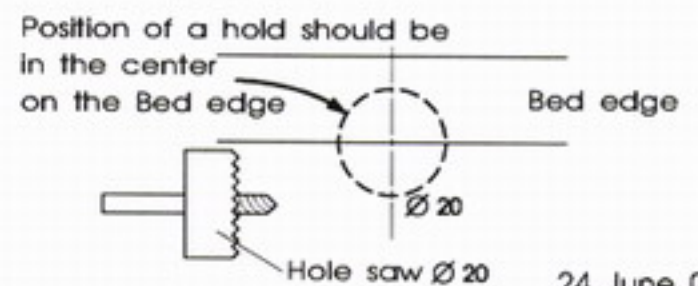

figure F.

Then hook it with the bed edge by bolt M8 x 70 **1** tightly. After that cover with the plastic case that is already well-installed KWICK KLAMP at 6 positions.

**5** In case of having a liner, drilling a hole on the liner by using HOLE SAW with diameter size of 20mm. measuring at the center position.



## WIRING DIAGRAM FOR S-560 MINOR CHANGE

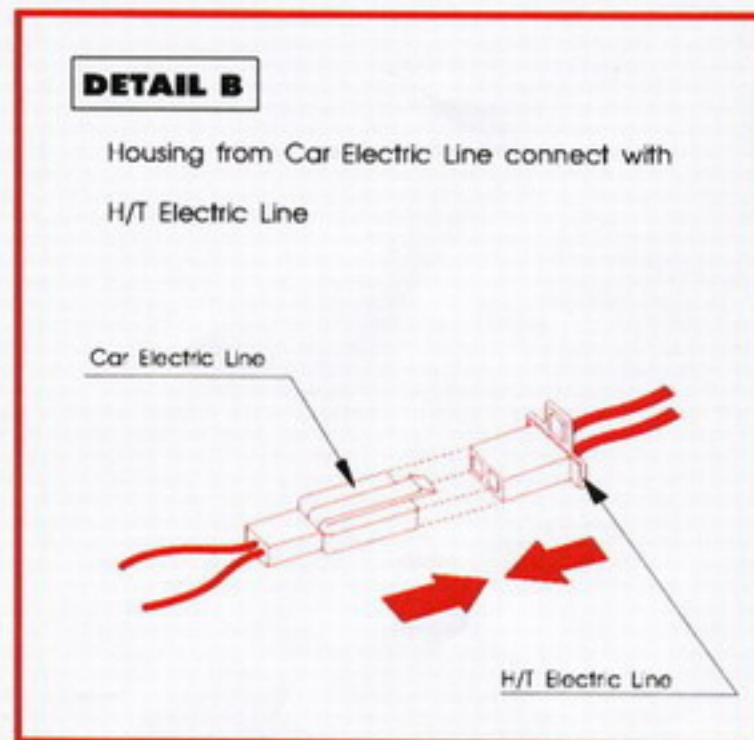
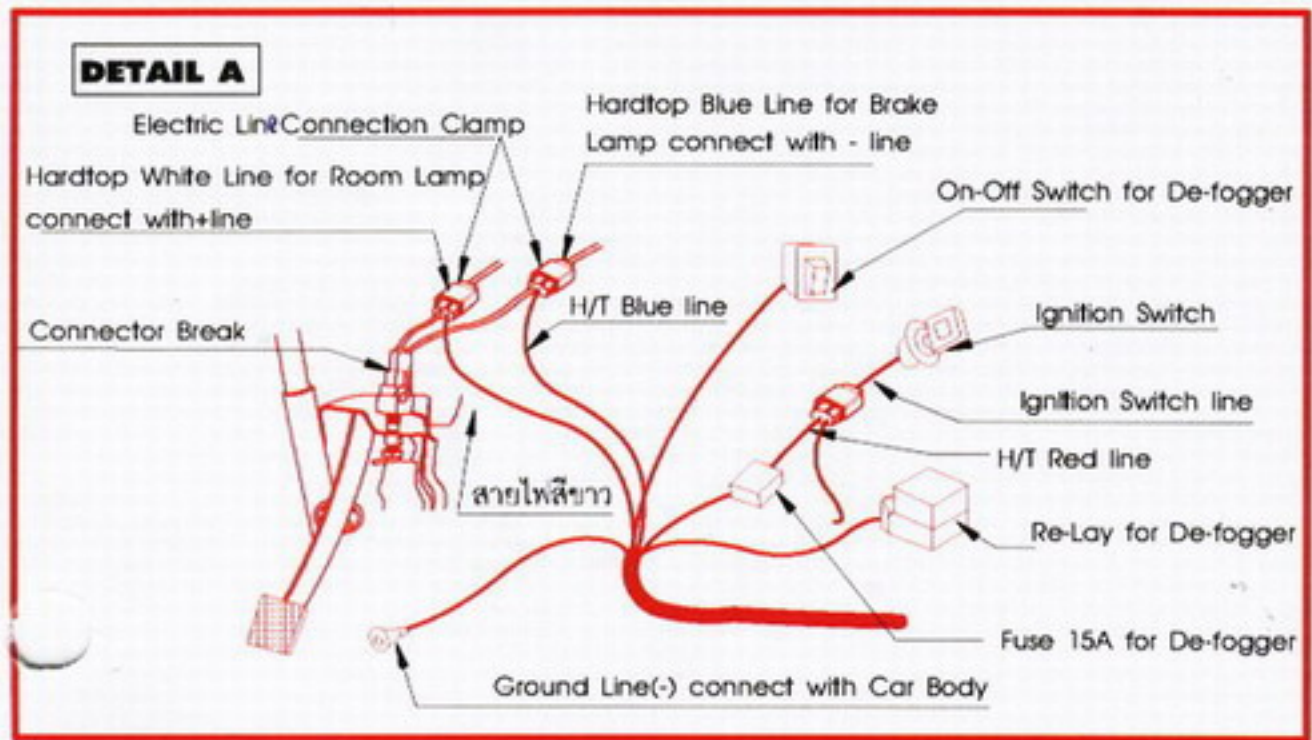
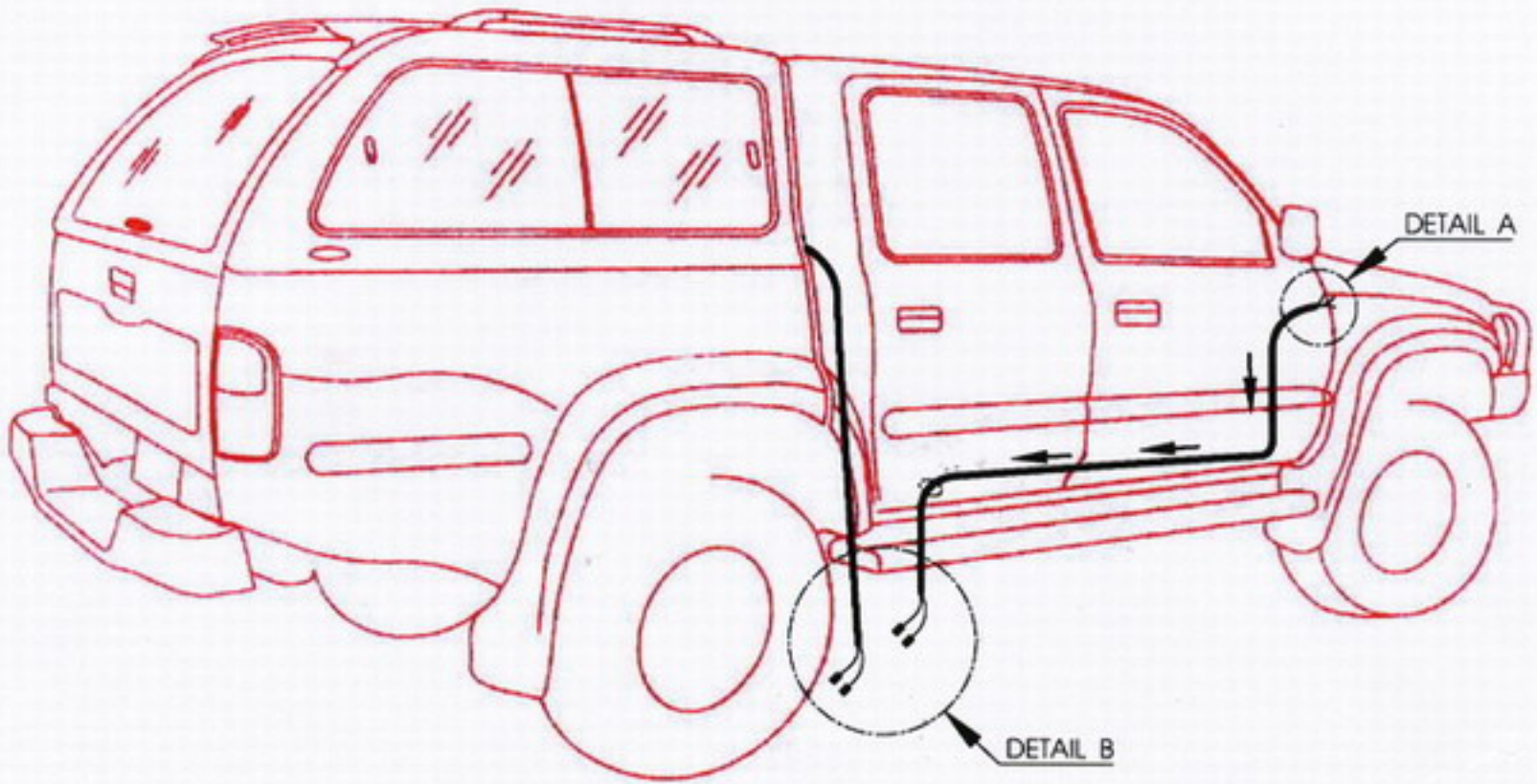

1. Ignition Switch on and Start

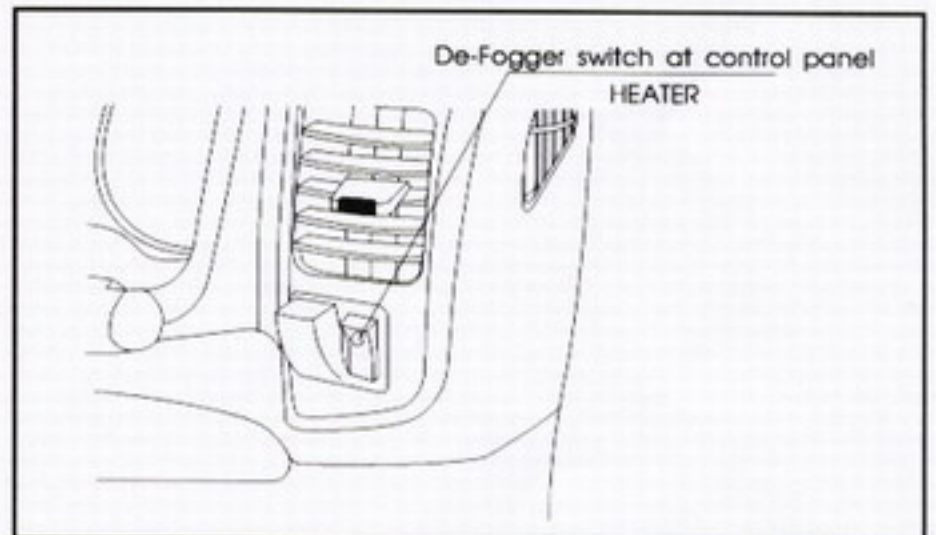
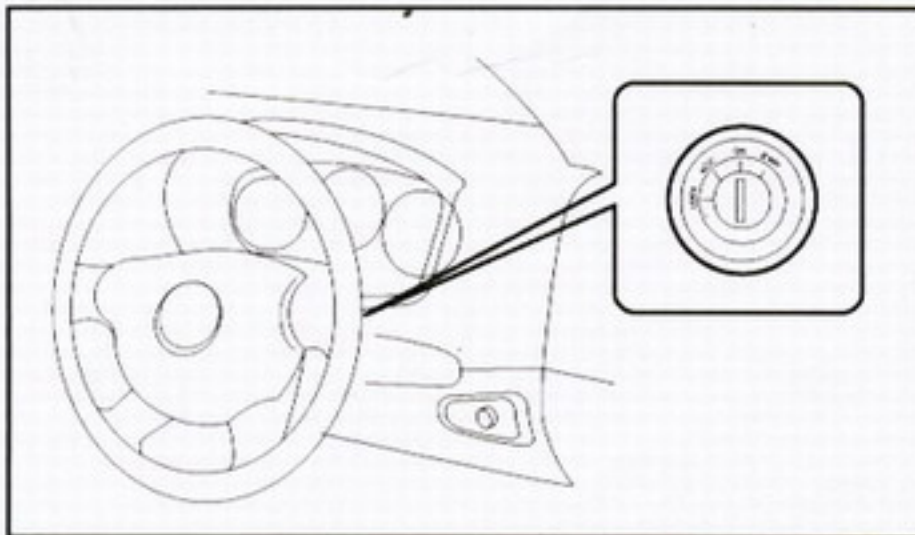

2. Switch on De-Fogger Switch

Caution !!  
When the fog at the rear glass door disappear please switch off the de-fogger switch